

32 903 000 ATLANTA WASCHTISCHBATTERIE MIT ARMHEBEL 1/2"

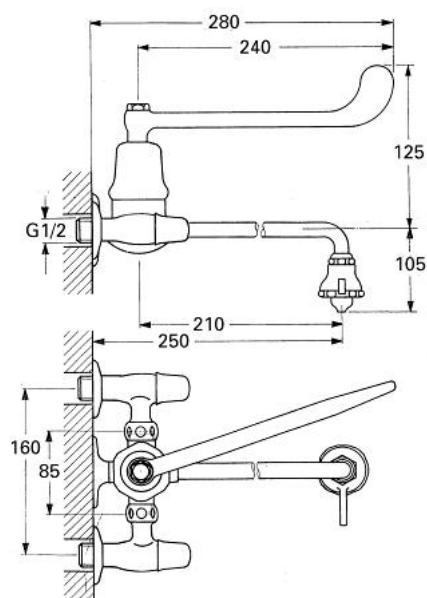

PRODUKTBESCHREIBUNG

- Colour: chrom
- für Ärztewaschtische
- Wandmontage
- Rohrauslauf mit Brausekopf umstellbar:
- Strahl/Brause
- Vorreguliertventile
- GROHE Long-Life Oberfläche

Technical drawing of a mechanical assembly, likely a pump or valve mechanism, showing various components and dimensions. The drawing includes a main assembly view and a detailed view of a component labeled '3'.

Dimensions and Labels:

- 1:** Dimension for the main assembly.
- 2:** Dimension for the main assembly.
- 3:** Dimension for the detailed view of component 3.
- 3.1:** Dimension for the detailed view of component 3.
- 3.2:** Dimension for the detailed view of component 3.
- 3.3:** Dimension for the detailed view of component 3.
- 3.4:** Dimension for the detailed view of component 3.
- 2.1:** Dimension for the main assembly.
- 2.2:** Dimension for the main assembly.
- 2.3:** Dimension for the main assembly.
- 2.3.1:** Dimension for the main assembly.
- 2.3.2:** Dimension for the main assembly.
- 2.3.3:** Dimension for the main assembly.
- 2.3.4:** Dimension for the main assembly.
- 4:** Dimension for the main assembly.

Other Labels:

- Drive:** Label for the drive mechanism.
- Stop:** Label for the stop mechanism.
- 2.1:** Label for the main assembly.
- 2.2:** Label for the main assembly.
- 2.3:** Label for the main assembly.
- 2.3.1:** Label for the main assembly.
- 2.3.2:** Label for the main assembly.
- 2.3.3:** Label for the main assembly.
- 2.3.4:** Label for the main assembly.

- 1: Armhebel (Order-nr. 45395000)
- 2: Oberteil 1/2" (Order-nr. 11148000)
 - 2.1: Steckschlüssel 1/2" (Order-nr. 02277000)
 - 2.2: Oberteil 1/2" (Order-nr. 07146000)
 - 2.2.1: O-Ring Ø6 x Ø2 (Order-nr. 0128300M)
 - 2.2.2: O-Ring Ø18,2 x Ø1,7 (Order-nr. 0392400M)
 - 2.2.3: Dichtung (Order-nr. 0529100M)
- 3: Regulieroberteil 1/2" (Order-nr. 06458000)
 - 3.1: Kegel, warm (Order-nr. 06849000)
 - 3.2: Kegel, kalt (Order-nr. 06848000)
 - 3.3: Dichtung (Order-nr. 0285100M)
- 4: Auslaufbrauseumstellbar M22 x 1 (Order-nr. 13904000)