

## 33 188 002 EUROSMART STANDARD EINHAND-WASCHTISCHBATTERIE, 1/2" S-SIZE

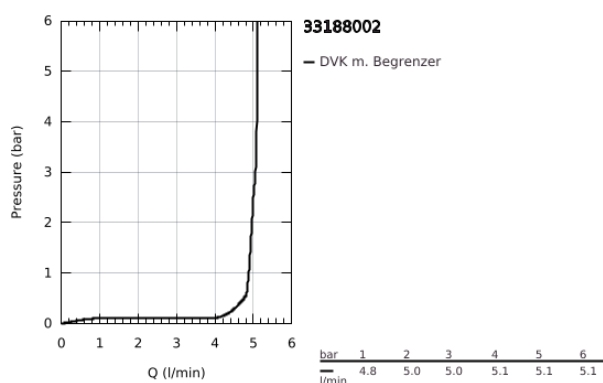

### PRODUKTBESCHREIBUNG

- Colour: chrom
- Einlochmontage
- Bedienungshebel aus Metall
- GROHE SilkMove 35 mm Keramikkartusche
- variabel einstellbare Mengenbegrenzung
- mit Temperaturbegrenzer
- GROHE Long-Life Oberfläche
- GROHE Water Saving - weniger Wasser, perfekter Wasserfluss
- Maximaler Durchfluss (bei 3 bar): 5 l/min
- GROHE FastFixation Schnellbefestigungssystem
- versenkbare Kette
- flexible Anschlussschläuche

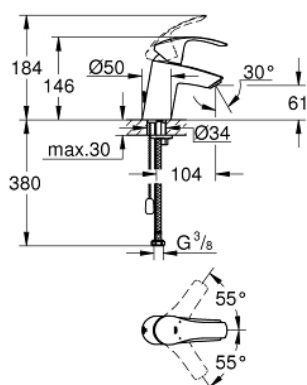

This exploded view diagram illustrates the assembly of a faucet. The components are numbered as follows: 1. Faucet handle, 2. O-ring, 3. Cartridge, 4. O-ring, 5. Faucet body, 6. O-ring, 7. Faucet body, 8. Faucet body, 9. Faucet body. The diagram shows the spatial relationship between these parts, indicating how they fit together to form the complete faucet assembly.

\* Optional accessories